

# AR16 W 6,3/7,0 x L

## SANDWICH PANELS SCREWS



### PRODUCT CHARACTERISTICS

Self-tapping drilling screws with double thread, made of hardened carbon steel, with hexagon head and with mounted steel or aluminium washer with EPDM attached

|  |               |
|--|---------------|
| HEXAGONAL HEAD SIZE                            | 8 mm          |
| MATERIAL OF SUPPORTING STRUCTURE               | steel         |
| MIN. THICKNESS OF SUPPORTING STRUCTURE (T min) | 4,0 mm        |
| DRILLING CAPACITY (DC)                         | 16,0 mm       |
| POSSIBILITY OF PAINTING                        | YES           |
| PAINT COATING THICKNESS                        | approx. 50 µm |
| RECOMMENDED SCREWDRIVER SPEED                  | 1200 rev/min  |
| RECOMMENDED TIGHTENING TORQUE                  | 6 Nm          |

### SCREW SIZE AND OTHER UTILITY DATA

| AVAILABLE SIZES<br>dxL [mm] | MTmin<br>[mm] | MTmax<br>[mm] | MATERIAL     | TYPE OF<br>ANTICORROSION<br>COATING | USED WASHERS |
|-----------------------------|---------------|---------------|--------------|-------------------------------------|--------------|
| 6,3/7,0x85                  | 34            | 53            | carbon steel | *CS<br>*CSG<br>*CSE                 | 19ZN, 19AL   |
| 6,3/7,0x105                 | 54            | 73            |              |                                     |              |
| 6,3/7,0x125                 | 58            | 93            |              |                                     |              |
| 6,3/7,0x135                 | 68            | 103           |              |                                     |              |
| 6,3/7,0x155                 | 68            | 123           |              |                                     |              |
| 6,3/7,0x160                 | 73            | 128           |              |                                     |              |
| 6,3/7,0x190                 | 103           | 158           |              |                                     |              |
| 6,3/7,0x215                 | 128           | 183           |              |                                     |              |
| 6,3/7,0x250                 | 163           | 218           |              |                                     |              |
| 6,3/7,0x315                 | 228           | 283           |              |                                     |              |

CS - carbon steel coated with zinc coating with a minimum thickness of 12 microns (optionally 24 microns)

CSG - carbon steel coated with zinc coating with a minimum thickness of 5 microns with additional Eco-GrePert ceramic coating (**CORROSION RESISTANCE UP TO C4 CATEGORY**)

CSE - carbon steel with EsC coating (**CORROSION RESISTANCE UP TO C4 CATEGORY**)

ZN - galvanized carbon steel, AL - aluminium

MTmin - minimum thickness of the fixed elements

MTmax - maximum thickness of the fixed elements including thickness of supporting structure

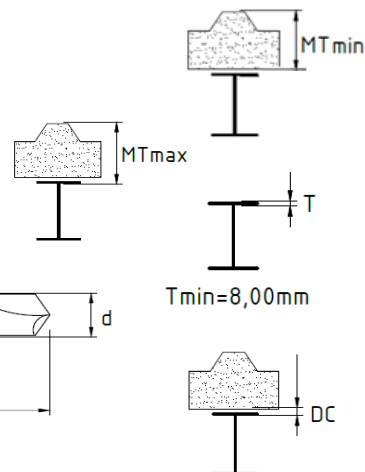
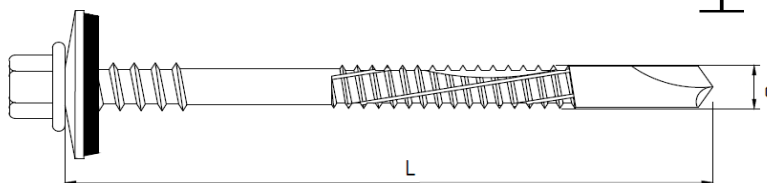

**SELECTED CHARACTERISTIC RESISTANCES PER SHEAR \***

**a) with 19ZN washer**

| Characteristic resistance [kN] |  |       |       |        |
|--------------------------------|--|-------|-------|--------|
| Thickness of facing of SP [mm] | Thickness of supporting structure [mm] |       |       |        |
|                                | 8,00                                   | 10,00 | 12,00 | ≥15,00 |
| 0,40                           | 0,70                                   | 0,70  | 0,70  | 0,70   |
| 0,50                           | 1,23                                   | 1,23  | 1,23  | 1,23   |
| 0,63                           | 1,62                                   | 1,62  | 1,62  | 1,62   |
| 0,75                           | 1,90                                   | 1,90  | 1,90  | 1,90   |
| 1,00                           | 1,90                                   | 1,90  | 1,90  | 1,90   |

**b) with 19AL washer**

| Characteristic resistance [kN] |  |       |       |        |
|--------------------------------|--|-------|-------|--------|
| Thickness of facing of SP [mm] | Thickness of supporting structure [mm] |       |       |        |
|                                | 8,00                                   | 10,00 | 12,00 | ≥15,00 |
| 0,40                           | 0,70                                   | 0,70  | 0,70  | 0,70   |
| 0,50                           | 1,23                                   | 1,23  | 1,23  | 1,23   |
| 0,63                           | 1,62                                   | 1,62  | 1,62  | 1,62   |
| 0,75                           | 1,90                                   | 1,90  | 1,90  | 1,90   |
| 1,00                           | 1,90                                   | 1,90  | 1,90  | 1,90   |

**SELECTED CHARACTERISTIC RESISTANCES PER PULL-OUT \***

**a) with 19ZN washer**

| Characteristic resistance [kN] |  |       |       |        |
|--------------------------------|--|-------|-------|--------|
| Thickness of facing of SP [mm] | Thickness of supporting structure [mm] |       |       |        |
|                                | 8,00                                   | 10,00 | 12,00 | ≥15,00 |
| 0,40                           | 2,19                                   | 2,19  | 2,19  | 2,19   |
| 0,50                           | 3,03                                   | 3,03  | 3,03  | 3,03   |
| 0,63                           | 4,02                                   | 4,02  | 4,02  | 4,02   |
| 0,75                           | 4,45                                   | 4,45  | 4,45  | 4,45   |
| 1,00                           | 4,45                                   | 4,45  | 4,45  | 4,45   |

**b) with 19AL washer**

| Characteristic resistance [kN] |  |       |       |        |
|--------------------------------|--|-------|-------|--------|
| Thickness of facing of SP [mm] | Thickness of supporting structure [mm] |       |       |        |
|                                | 8,00                                   | 10,00 | 12,00 | ≥15,00 |
| 0,40                           | 2,19                                   | 2,19  | 2,19  | 2,19   |
| 0,50                           | 3,00                                   | 3,00  | 3,00  | 3,00   |
| 0,63                           | 3,79                                   | 3,79  | 3,79  | 3,79   |
| 0,75                           | 4,12                                   | 4,12  | 4,12  | 4,12   |
| 1,00                           | 4,12                                   | 4,12  | 4,12  | 4,12   |

**SELECTED MAXIMUM DISPLACEMENTS OF HEADS OF SCREWS \***

**a) with 19ZN washer**

| Max. displacement of head of screw, by displacement of outer facing [mm] |  |       |       |        |
|--|--|-------|-------|--------|
| Thickness of sandwich panel [mm]   | Thickness of supporting structure [mm] |       |       |        |
|  | 8,00                                   | 10,00 | 12,00 | ≥15,00 |
| 30,00  | 0,70                                   | 0,70  | 0,70  | 0,70   |
| 60,00  | 1,40                                   | 1,40  | 1,40  | 1,40   |
| 90,00  | 2,10                                   | 2,10  | 2,10  | 2,10   |
| >140,00  | 3,20                                   | 3,20  | 3,20  | 3,20   |

**b) with 19AL washer**

| Max. displacement of head of screw, by displacement of outer facing [mm] |  |       |       |        |
|--|--|-------|-------|--------|
| Thickness of sandwich panel [mm]   | Thickness of supporting structure [mm] |       |       |        |
|  | 8,00                                   | 10,00 | 12,00 | ≥15,00 |
| 30,00  | 0,70                                   | 0,70  | 0,70  | 0,70   |
| 60,00  | 1,40                                   | 1,40  | 1,40  | 1,40   |
| 90,00  | 2,10                                   | 2,10  | 2,10  | 2,10   |
| >140,00  | 3,20                                   | 3,20  | 3,20  | 3,20   |

*\* This product data sheet shows only examples of fastenings resistances/displacements. Full information about resistances/displacements for introduced screws are described in the **ETA-19/0586** technical approval*

**PURPOSE AND SCOPE OF USE**

Screws for fixing sandwich panels to hot-rolled steel structures of big thickness or hardness

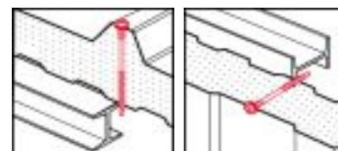

*This product data sheet is for information purposes only and does not constitute an offer within the meaning of Article 66 of the Civil Code par.1*

Info-GLOBAL Sp.j., 63-400 Ostrów Wielkopolski,  
67 Długa Street T +48 62 7372760 - F + 48 62 7372761  
biuro@info-global.pl – <http://www.info-global.pl>