

# AR12 W 5,5/6,3 x L

**Info-GLOBAL<sup>®</sup>**  
Fastening

## SANDWICH PANELS SCREWS



### PRODUCT CHARACTERISTICS

Self-tapping drilling screws with double thread, made of hardened carbon steel, with hexagon head and with mounted steel or aluminium washer with EPDM attached

|  |               |
|--|---------------|
| HEXAGONAL HEAD SIZE                            | 8 mm          |
| MATERIAL OF SUPPORTING STRUCTURE               | steel         |
| MIN. THICKNESS OF SUPPORTING STRUCTURE (T min) | 3,0 mm        |
| DRILLING CAPACITY (DC)                         | 12,0 mm       |
| POSSIBILITY OF PAINTING                        | YES           |
| PAINT COATING THICKNESS                        | approx. 50 µm |
| RECOMMENDED SCREWDRIVER SPEED                  | 1500 rev/min  |
| RECOMMENDED TIGHTENING TORQUE                  | 5 Nm          |

### SCREW SIZE AND OTHER UTILITY DATA

| AVAILABLE SIZES<br>dxL [mm] | MTmin<br>[mm] | MTmax<br>[mm] | MATERIAL     | TYPE OF<br>ANTICORROSION<br>COATING | USED WASHERS        |
|-----------------------------|---------------|---------------|--------------|-------------------------------------|---------------------|
| 5.5/6.3x70                  | 25            | 44            | carbon steel | *CS<br>*CSG<br>*CSE                 | 16ZN, 19ZN,<br>19AL |
| 5.5/6.3x90                  | 35            | 64            |              |                                     |                     |
| 5.5/6.3x110                 | 29            | 84            |              |                                     |                     |
| 5.5/6.3x130                 | 45            | 104           |              |                                     |                     |
| 5.5/6.3x150                 | 65            | 124           |              |                                     |                     |
| 5.5/6.3x175                 | 90            | 149           |              |                                     |                     |
| 5.5/6.3x185                 | 100           | 159           |              |                                     |                     |
| 5.5/6.3x200                 | 115           | 174           |              |                                     |                     |
| 5.5/6.3x230                 | 145           | 204           |              |                                     |                     |
| 5.5/6.3x285                 | 200           | 259           |              |                                     |                     |
| 5.5/6.3x330                 | 245           | 304           |              |                                     |                     |
| 5.5/6.3x285                 | 200           | 263           |              |                                     |                     |
| 5.5/6.3x330                 | 246           | 308           |              |                                     |                     |

CS - carbon steel coated with zinc coating with a minimum thickness of 12 microns (optionally 24 microns)

CSG - carbon steel coated with zinc coating with a minimum thickness of 5 microns with additional Eco-GrePert ceramic coating (**CORROSION RESISTANCE UP TO C4 CATEGORY**)

CSE - carbon steel with EsC coating (**CORROSION RESISTANCE UP TO C4 CATEGORY**)

ZN - galvanized carbon steel, AL - aluminium

MTmin - minimum thickness of the fixed elements

MTmax - maximum thickness of the fixed elements including thickness of supporting structure

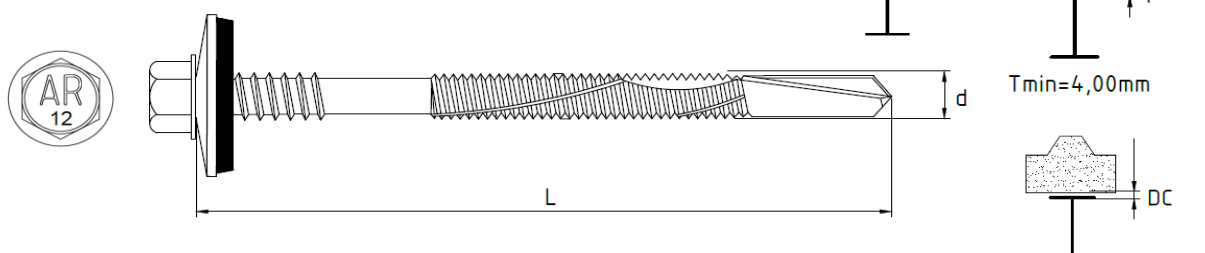

**SELECTED CHARACTERISTIC RESISTANCES PER SHEAR \***

**a) with 16ZN washer**

| Characteristic resistance [kN] |  |      |      |        |
|--------------------------------|--|------|------|--------|
| Thickness of facing of SP [mm] | Thickness of supporting structure [mm] |      |      |        |
|                                | 4,00                                   | 6,00 | 8,00 | ≥11,00 |
| 0,40                           | 0,70                                   | 0,70 | 0,70 | 0,70   |
| 0,50                           | 1,27                                   | 1,27 | 1,27 | 1,27   |
| 0,63                           | 1,59                                   | 1,59 | 1,59 | 1,59   |
| 0,75                           | 1,86                                   | 1,86 | 1,86 | 1,86   |
| 1,00                           | 1,86                                   | 1,86 | 1,86 | 1,86   |

**b) with 19AL washer**

| Characteristic resistance [kN] |  |      |      |        |
|--------------------------------|--|------|------|--------|
| Thickness of facing of SP [mm] | Thickness of supporting structure [mm] |      |      |        |
|                                | 4,00                                   | 6,00 | 8,00 | ≥11,00 |
| 0,40                           | 0,70                                   | 0,70 | 0,70 | 0,70   |
| 0,50                           | 1,27                                   | 1,27 | 1,27 | 1,27   |
| 0,63                           | 1,59                                   | 1,59 | 1,59 | 1,59   |
| 0,75                           | 1,86                                   | 1,86 | 1,86 | 1,86   |
| 1,00                           | 1,86                                   | 1,86 | 1,86 | 1,86   |

**SELECTED CHARACTERISTIC RESISTANCES PER PULL-OUT \***

**a) with 16ZN washer**

| Characteristic resistance [kN] |  |      |      |        |
|--------------------------------|--|------|------|--------|
| Thickness of facing of SP [mm] | Thickness of supporting structure [mm] |      |      |        |
|                                | 4,00                                   | 6,00 | 8,00 | ≥11,00 |
| 0,40                           | 2,00                                   | 2,00 | 2,00 | 2,00   |
| 0,50                           | 2,81                                   | 2,81 | 2,81 | 2,81   |
| 0,63                           | 3,53                                   | 3,53 | 3,53 | 3,53   |
| 0,75                           | 4,34                                   | 4,34 | 4,34 | 4,34   |
| 1,00                           | 4,34                                   | 4,34 | 4,34 | 4,34   |

**b) with 19AL washer**

| Characteristic resistance [kN] |  |      |      |        |
|--------------------------------|--|------|------|--------|
| Thickness of facing of SP [mm] | Thickness of supporting structure [mm] |      |      |        |
|                                | 4,00                                   | 6,00 | 8,00 | ≥11,00 |
| 0,40                           | 2,19                                   | 2,19 | 2,19 | 2,19   |
| 0,50                           | 3,00                                   | 3,00 | 3,00 | 3,00   |
| 0,63                           | 3,79                                   | 3,79 | 3,79 | 3,79   |
| 0,75                           | 4,12                                   | 4,12 | 4,12 | 4,12   |
| 1,00                           | 4,12                                   | 4,12 | 4,12 | 4,12   |

**SELECTED MAXIMUM DISPLACEMENTS OF HEADS OF SCREWS \***

**a) with 16ZN washer**

| Max. displacement of head of screw, by displacement of outer facing [mm] |  |      |      |        |
|--|--|------|------|--------|
| Thickness of sandwich panel [mm]   | Thickness of supporting structure [mm] |      |      |        |
|  | 4,00                                   | 6,00 | 8,00 | ≥11,00 |
| 30,00  | 0,70                                   | 0,70 | 0,70 | 0,70   |
| 60,00  | 1,40                                   | 1,40 | 1,40 | 1,40   |
| 90,00  | 2,10                                   | 2,10 | 2,10 | 2,10   |
| >140,00  | 3,20                                   | 3,20 | 3,20 | 3,20   |

**b) with 19AL washer**

| Max. displacement of head of screw, by displacement of outer facing [mm] |  |      |      |        |
|--|--|------|------|--------|
| Thickness of sandwich panel [mm]   | Thickness of supporting structure [mm] |      |      |        |
|  | 4,00                                   | 6,00 | 8,00 | ≥11,00 |
| 30,00  | 0,70                                   | 0,70 | 0,70 | 0,70   |
| 60,00  | 1,40                                   | 1,40 | 1,40 | 1,40   |
| 90,00  | 2,10                                   | 2,10 | 2,10 | 2,10   |
| >140,00  | 3,20                                   | 3,20 | 3,20 | 3,20   |

*\* This product data sheet shows only examples of fastenings resistances/displacements. Full information about resistances/displacements for introduced screws are described in the **ETA-19/0586** technical approval*

**PURPOSE AND SCOPE OF USE**

Screws for fixing sandwich panels to hot-rolled steel structures

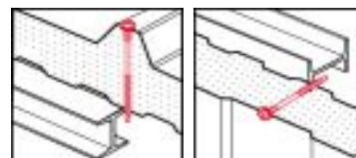

This product data sheet is for information purposes only and does not constitute an offer within the meaning of Article 66 of the Civil Code par.1

Info-GLOBAL Sp.j., 63-400 Ostrów Wielkopolski,  
67 Długa Street T +48 62 7372760 - F + 48 62 7372761  
biuro@info-global.pl – <http://www.info-global.pl>